

23 College Drive, Whalley Range, Manchester, M16 0AD



**JP&Brimelow**  
ESTATE AGENTS



# Offers In The Region Of £425,000

**\*\*VIDEO TOUR AVAILABLE\*\*** An attractive & beautifully presented, THREE BEDROOMED, bay fronted, period, semi-detached property situated in a highly popular residential location in Whalley Range off College Road. Within walking distance to fantastic transport links, giving you direct access into the City Centre. links to motorways and the Metrolink station nearby in Firswood, Alexandra Park, St Bede's College & William Hulme Grammar School are all on your door step as is Manley Park Primary School. The well-planned accommodation comprises; Entrance vestibule, entrance hallway, a lounge with bay window to the front aspect and an impressive open plan dining room/fitted kitchen freshly fitted with granite worktops, leading out into the rear enclosed garden. To the first floor there is a landing with three well-proportioned bedrooms and a four-piece newly fitted white family bathroom. The property benefits from period features throughout, partial double glazing, warmed by gas fired central heating, a front garden with an attractive enclosed landscaped rear lawned garden. Early viewing is recommended to fully appreciate this lovely home.







## EPC Chart

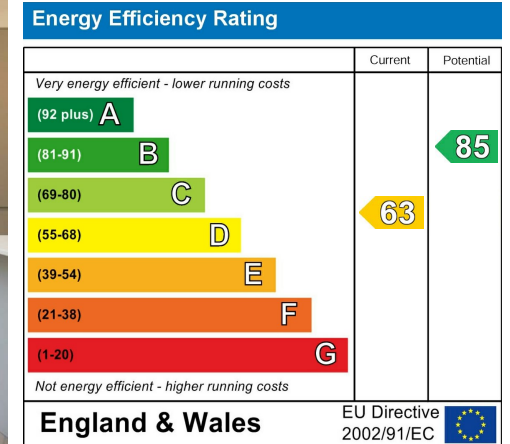

Tenure: Freehold Council Tax Band: B

## Ground Floor

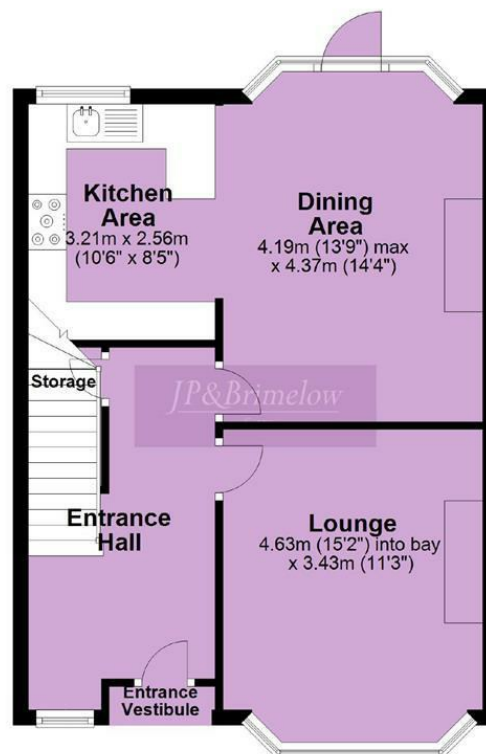

## First Floor

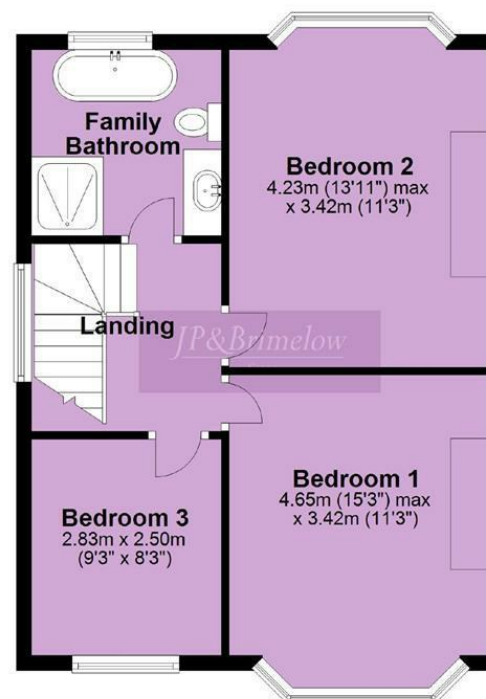

Chorlton & Didsbury Ltd  
 430 Barlow Moor Road, Chorlton, Manchester, M21 8AD  
 Chorlton: 0161 882 2233 Didsbury: 0161 448 0622  
 E: [chorlton@jpbrimelow.co.uk](mailto:chorlton@jpbrimelow.co.uk) [www.jpbrimelow.co.uk](http://www.jpbrimelow.co.uk)



**JP&Brimelow**  
 ESTATE AGENTS

NOTICE: J P & Brimelow Chorlton & Didsbury Ltd for themselves and for the vendors or lessors of this property whose agents they are give notice that:

- (i) the particulars are set out as a general outline only for the guidance of intending purchasers or lessees, and do not constitute, nor constitute part of, an offer or contract;
- (ii) all descriptions, dimensions, references to the condition and necessary permissions for use and occupation, and other details are given in good faith and are believed to be correct but any intending purchasers or tenants should not rely on them as statements or representations of fact but must satisfy themselves by inspection or otherwise as to the correctness of each of them;
- (iii) no person in the employment of JP & Brimelow Ltd has any authority to make or give any representation or warranty whatever in relation to this property.



Follow us on Twitter @jpandbrimelows