

14 Rostherne Avenue, Old Trafford, Trafford, M16 7QH



JP&Brimelow
ESTATE AGENTS

Offers In The Region Of £340,000

 3  1  2  D

VIDEO TOUR AVAILABLE A well-presented THREE BEDROOM, bay fronted semi-detached property situated on a highly popular residential road, off Kings Road in Old Trafford. On the borders of Whalley Range, the property is close to Manley Park and Seymour Park "outstanding" registered local Primary Schools. Close by to the Metrolink station at Trafford Bar giving direct access to Manchester City Centre, Media City and Manchester International Airport. The well-planned accommodation consists of an entrance porch, entrance hallway with useful under stairs storage, dining room with bay window to the front aspect, lounge with box bay window to the rear with views out into the garden and a kitchen with access out into the garden. To the first floor a landing reveals three good sized bedrooms the master benefitting from a built in and a three-piece bathroom completes this home. The property benefits from gas fired central heating, high ceilings through out, a useful garage and a rear enclosed garden.





EPC Chart

Energy Efficiency Rating		
	Current	Potential
Very energy efficient - lower running costs		
(92 plus) A		84
(81-91) B		
(69-80) C		
(55-68) D	60	
(39-54) E		
(21-38) F		
(1-20) G		
Not energy efficient - higher running costs		
England & Wales		EU Directive 2002/91/EC 



Tenure: **Leasehold** Council Tax Band: **C**

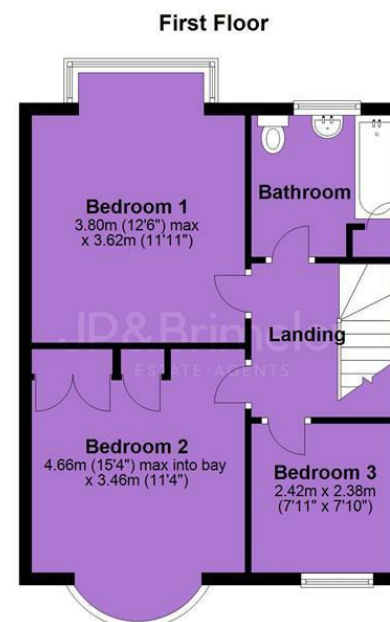
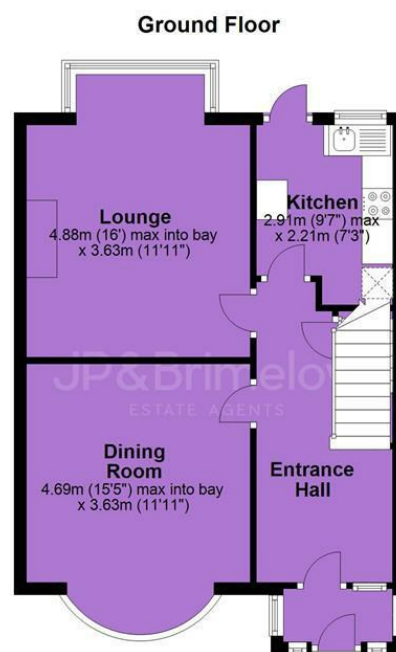
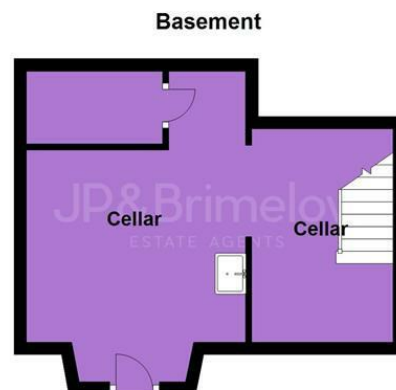

JP & Brimelow Estate Agents Ltd
 430 Barlow Moor Road, Manchester, M21 8AD
 Tel: 0161 8822233
 E: sales@jpbrimelow.co.uk www.jpandbrimelow.co.uk



JP & Brimelow
 ESTATE AGENTS

NOTICE: JP & Brimelow Estate Agents Ltd for themselves and for the vendors or lessors of this property whose agents they are give notice that:

- (i) the particulars are set out as a general outline only for the guidance of intending purchasers or lessees, and do not constitute, nor constitute part of, an offer or contract;
- (ii) all descriptions, dimensions, references to the condition and necessary permissions for use and occupation, and other details are given in good faith and are believed to be correct but any intending purchasers or tenants should not rely on them as statements or representations of fact but must satisfy themselves by inspection or otherwise as to the correctness of each of them;
- (iii) no person in the employment of JP & Brimelow Estate Agents Ltd has any authority to make or give any representation or warranty whatever in relation to this property.

jpandbrimelowestateagents

@jpandbrimelow