

23B Burford Road, Whalley Range, Manchester, M16 8EW



**JP&Brimelow**  
ESTATE AGENTS



# Offers In The Region Of £325,000

 3  1  2  E

\*\*\*VIDEO TOUR AVAILABLE\*\*\* A THREE BEDROOM period, semi-detached property nestled on a sought-after cul-de-sac, just off Withington Road. Burford Road is a picturesque tree-lined cul-de-sac, conveniently located within close proximity to both the vibrant heart of Whalley Range and the bustling centre of Chorlton. The well-planned accommodation consists of a porch, an entrance hallway, a lounge opening through to a good-sized dining room, a sun room with views into the rear lawned garden and a fitted kitchen with access into the enclosed garden, completing the ground floor. To the first floor there is a landing leading to two double bedrooms, a two-piece bathroom, a separate W.C and a further single bedroom. The property offers the advantage of gas-fired central heating and both a front garden with a driveway and a well-maintained sizable garden to the rear. Walking distance to fantastic transport links giving direct access into the city centre, with links to motorways and trams nearby. Alexandra Park, St Bede's, William Hulme Grammar School and good local primary schools are all on your door step. OFFERED WITH NO VENDOR CHAIN.







## EPC Chart

Energy Efficiency Rating		Current	Potential
Very energy efficient - lower running costs			
(92 plus) <b>A</b>			<b>84</b>
(81-91) <b>B</b>			
(69-80) <b>C</b>			
(55-68) <b>D</b>		<b>45</b>	
(39-54) <b>E</b>			
(21-38) <b>F</b>			
(1-20) <b>G</b>			
Not energy efficient - higher running costs			
<b>England &amp; Wales</b>		EU Directive 2002/91/EC	



Tenure: **Freehold** Council Tax Band: **C**

## Ground Floor

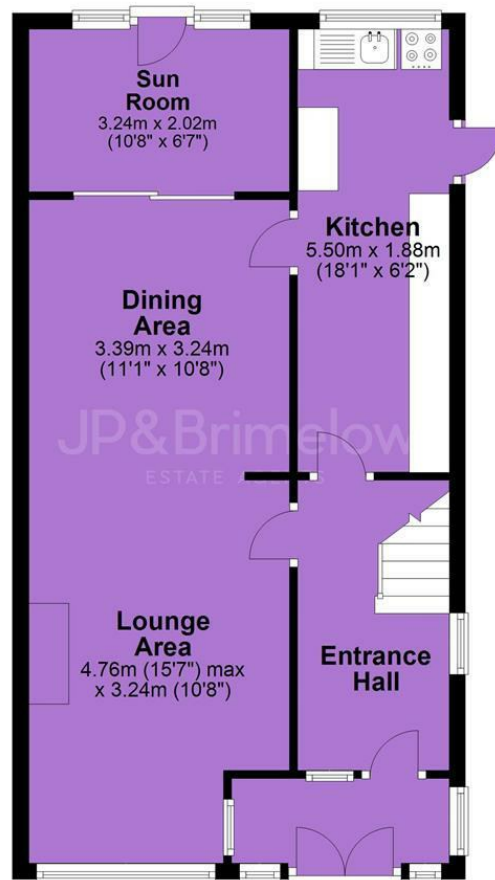

## First Floor

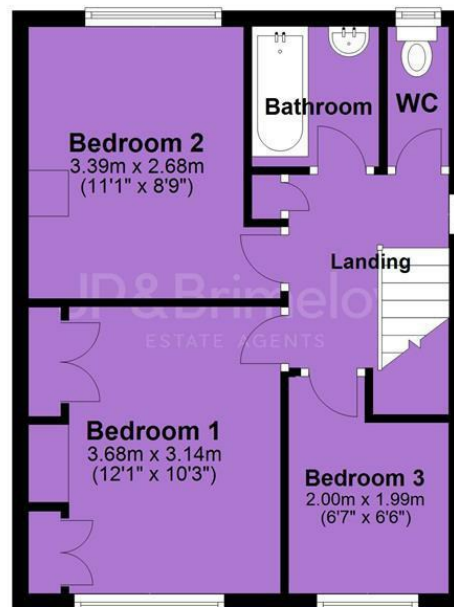

JP & Brimelow Estate Agents Ltd  
430 Barlow Moor Road, Manchester, M21 8AD  
Tel: 0161 8822233  
E: sales@jpbrimelow.co.uk www.jpandbrimelow.co.uk



**JP & Brimelow**  
ESTATE AGENTS

NOTICE: JP & Brimelow Estate Agents Ltd for themselves and for the vendors or lessors of this property whose agents they are give notice that:

- (i) the particulars are set out as a general outline only for the guidance of intending purchasers or lessees, and do not constitute, nor constitute part of, an offer or contract;
- (ii) all descriptions, dimensions, references to the condition and necessary permissions for use and occupation, and other details are given in good faith and are believed to be correct but any intending purchasers or tenants should not rely on them as statements or representations of fact but must satisfy themselves by inspection or otherwise as to the correctness of each of them;
- (iii) no person in the employment of JP & Brimelow Estate Agents Ltd has any authority to make or give any representation or warranty whatever in relation to this property.

jpandbrimelowestateagents

@jpandbrimelow