

228 Darley Avenue, Chorlton, Manchester, M21 7HX



JP&Brimelow
ESTATE AGENTS

Offers In The Region Of £335,000

 3  1  2  D

VIDEO TOUR AVAILABLE A well-presented and spacious, THREE BEDROOM semi-detached home, situated on a sought-after residential avenue, off Hardy Lane in Chorlton. Ideally positioned near Chorlton Water Park, Chorlton Park, and Chorlton Golf Club, this property offers convenient access to transport links, including the Metrolink and bus routes on Barlow Moor Road, providing easy connections to Manchester City Centre and Manchester International Airport. The location is perfect for enjoying the amenities of both West Didsbury and Chorlton, as well as being close to local primary schools, parks, and the motorway network. In brief the well-planned accommodation consists of an entrance hall, a spacious lounge to the front aspect, a useful storage cupboard leading through to a W.C, a fitted kitchen, and a conservatory/ dining area with view and access out into the rear garden completing the ground. To the first floor there are three good sized bedrooms, and a three-piece family bathroom completing this delightful property. The property benefits from gas fired central heating, an alarm system, a large unique outbuilding providing potential for a home office, gym etc with both electric and wifi and both front and rear enclosed gardens.





EPC Chart

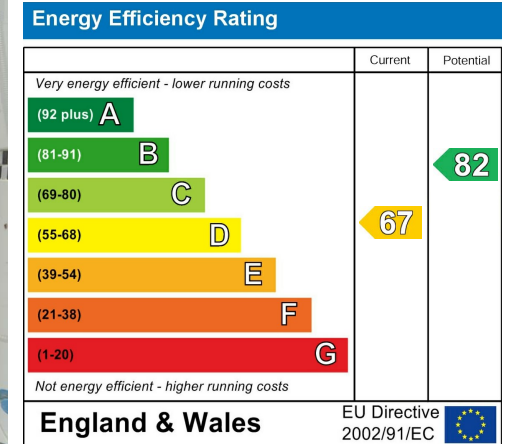

Tenure: **Freehold** Council Tax Band: **A**

Ground Floor

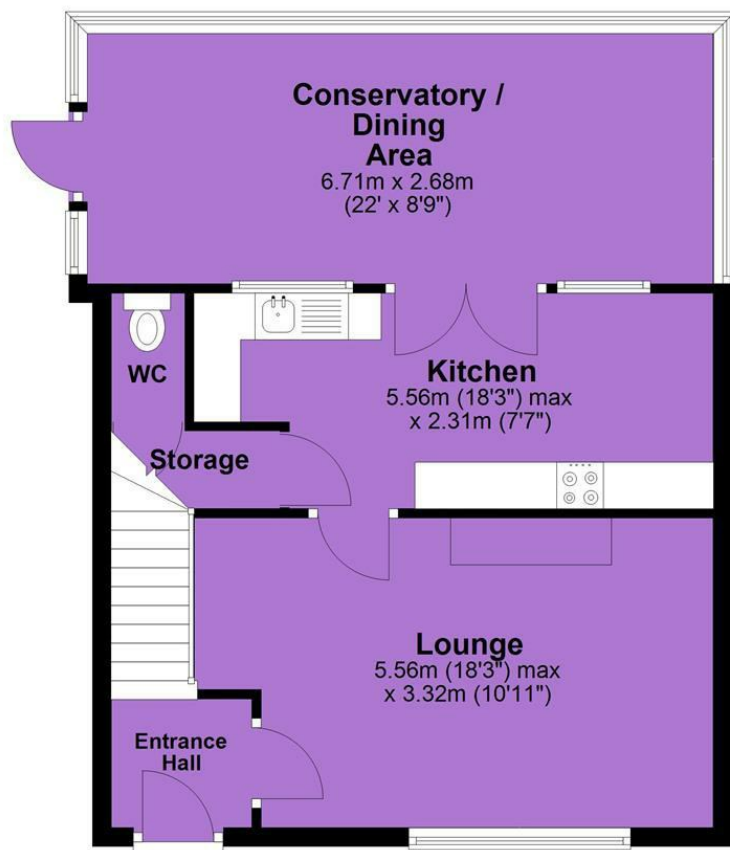

First Floor



JP & Brimelow Estate Agents Ltd
430 Barlow Moor Road, Manchester, M21 8AD
Tel: 0161 8822233
E: sales@jpbrimelow.co.uk www.jpandbrimelow.co.uk



JP & Brimelow
ESTATE AGENTS

NOTICE: JP & Brimelow Estate Agents Ltd for themselves and for the vendors or lessors of this property whose agents they are give notice that:

- (i) the particulars are set out as a general outline only for the guidance of intending purchasers or lessees, and do not constitute, nor constitute part of, an offer or contract;
- (ii) all descriptions, dimensions, references to the condition and necessary permissions for use and occupation, and other details are given in good faith and are believed to be correct but any intending purchasers or tenants should not rely on them as statements or representations of fact but must satisfy themselves by inspection or otherwise as to the correctness of each of them;
- (iii) no person in the employment of JP & Brimelow Estate Agents Ltd has any authority to make or give any representation or warranty whatever in relation to this property.

jpandbrimelowestateagents

@jpandbrimelow